

# SUPPLEMENTAL RESTRAINT SYSTEM

600L0-02

## PRECAUTION

### CAUTION:

- **AVENSIS VERSO/PICNIC** is equipped with SRS, which consists of a driver airbag, front passenger airbag, side airbag and curtain shield airbag. Failure to carry out service operations in the correct sequence could cause the SRS to unexpectedly deploy during servicing, possibly leading to a serious accident. Further, if a mistake is made in servicing the SRS, it is possible that the SRS may fail to operate when required. Before performing servicing (including removal or installation of parts, inspection or replacement), be sure to read the following items carefully, then follow the correct procedures indicated in the repair manual.
- Wait at least 90 seconds after the ignition switch is turned to the "LOCK" position and the negative (-) terminal cable is disconnected from the battery.  
(The SRS is equipped with a back-up power source, so that if work is started within 90 seconds after disconnecting the negative (-) terminal cable of the battery, the SRS may be deployed.)
- Do not expose the horn button Assy, instrument panel passenger airbag Assy, airbag sensor Assy center, airbag sensor front, front seat airbag Assy, curtain shield airbag Assy or side airbag sensor Assy directly to hot air or flames.

### NOTICE:

- Malfunction symptoms of the SRS are difficult to confirm, so DTCs are the most important source of information when troubleshooting. When troubleshooting the SRS, always inspect DTCs before disconnecting the battery.
- Even in the case of a minor collision when the SRS does not deploy, the horn button Assy, instrument panel passenger airbag Assy, airbag sensor Assy center, airbag sensor front, front seat airbag Assy, curtain shield airbag Assy and side airbag sensor Assy should be inspected (see [page 60-10](#)).
- Before repair work, remove the airbag sensor if any kind of shock is likely to occur to the airbag sensor during the operation.
- Never use SRS parts from another vehicle. When replacing the parts, replace them with new ones.
- Never disassemble or repair the horn button Assy, instrument panel passenger airbag Assy, airbag sensor Assy center, airbag sensor front, front seat airbag Assy, curtain shield airbag Assy or side airbag sensor Assy in order to reuse it.
- If the horn button Assy, instrument panel passenger airbag Assy, airbag sensor Assy center, airbag sensor front, front seat airbag Assy, curtain shield airbag Assy or side airbag sensor Assy has been dropped, or if there are any cracks, dents or other defects in the case, bracket or connector, replace it with a new one.
- Use a volt/ohmmeter with high impedance (10 k $\Omega$ /V minimum) for troubleshooting the electrical circuits.
- Information labels are attached to the periphery of the SRS components. Follow the instructions in the caution.
- After work on the SRS is completed, perform the SRS warning light check (see [page 05-972](#)).
- When the negative (-) terminal cable is disconnected from the battery, the memory of the clock and audio system will be canceled. So before starting work, make a record of the contents memorized in the audio memory system. When work is finished, reset the audio system as it was before and adjust the clock. Never use a back-up power supply from outside the vehicle to avoid erasing the memory in each memory system.
- If the vehicle is equipped with a mobile communication system, refer to the precaution in the INTRODUCTION section.

1. SRS CONNECTORS

HINT:

SRS connectors are located as shown in the following illustration.

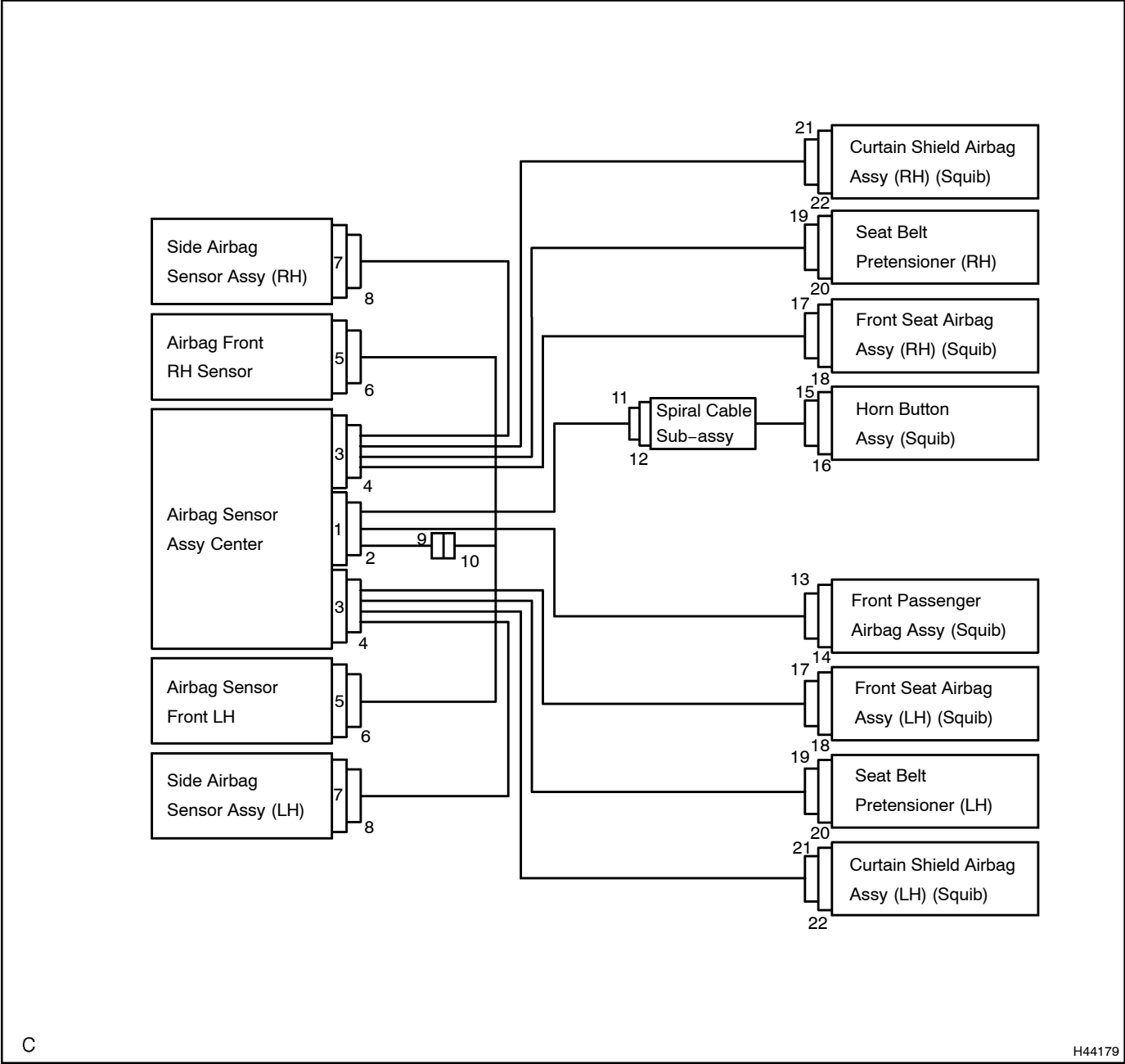

No.	Connector Type	Application
(1)	Terminal Twin-Lock Mechanism	Connectors 2, 4, 6, 8, 9, 10, 11, 15, 17, 21
(2)	Activation Prevention Mechanism	Connectors 2, 4, 12, 14, 16, 18, 20, 22
(3)	Electrical Connection Check Mechanism	Connectors 1, 2, 3, 4
(4)	Half Connection Prevention Mechanism	Connectors 6, 8, 9, 11, 15, 17, 21
(5)	Connector Lock Mechanism	Connectors 13, 17

- (a) All connectors in the SRS are colored yellow to distinguish them from other connectors. Some connectors have special functions, and are specially designed for the SRS. These connectors use durable gold-plated terminals, and are placed in the locations shown on the previous page to ensure high reliability.

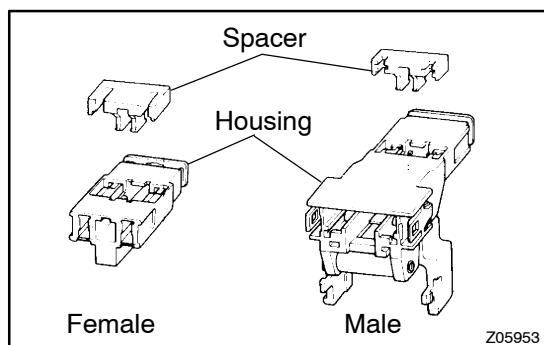

- (1) **Terminal twin-lock mechanism:**  
Each connector has a two-piece component consisting of a housing and a spacer. This design enables the terminal to be locked securely by two locking devices (the retainer and the lance) to prevent terminals from coming out.
- (2) **Activation prevention mechanism:**  
Each connector contains a short spring plate. When the connector is disconnected, the short spring plate automatically connects the positive (+) terminal and the negative (-) terminal of the squib.

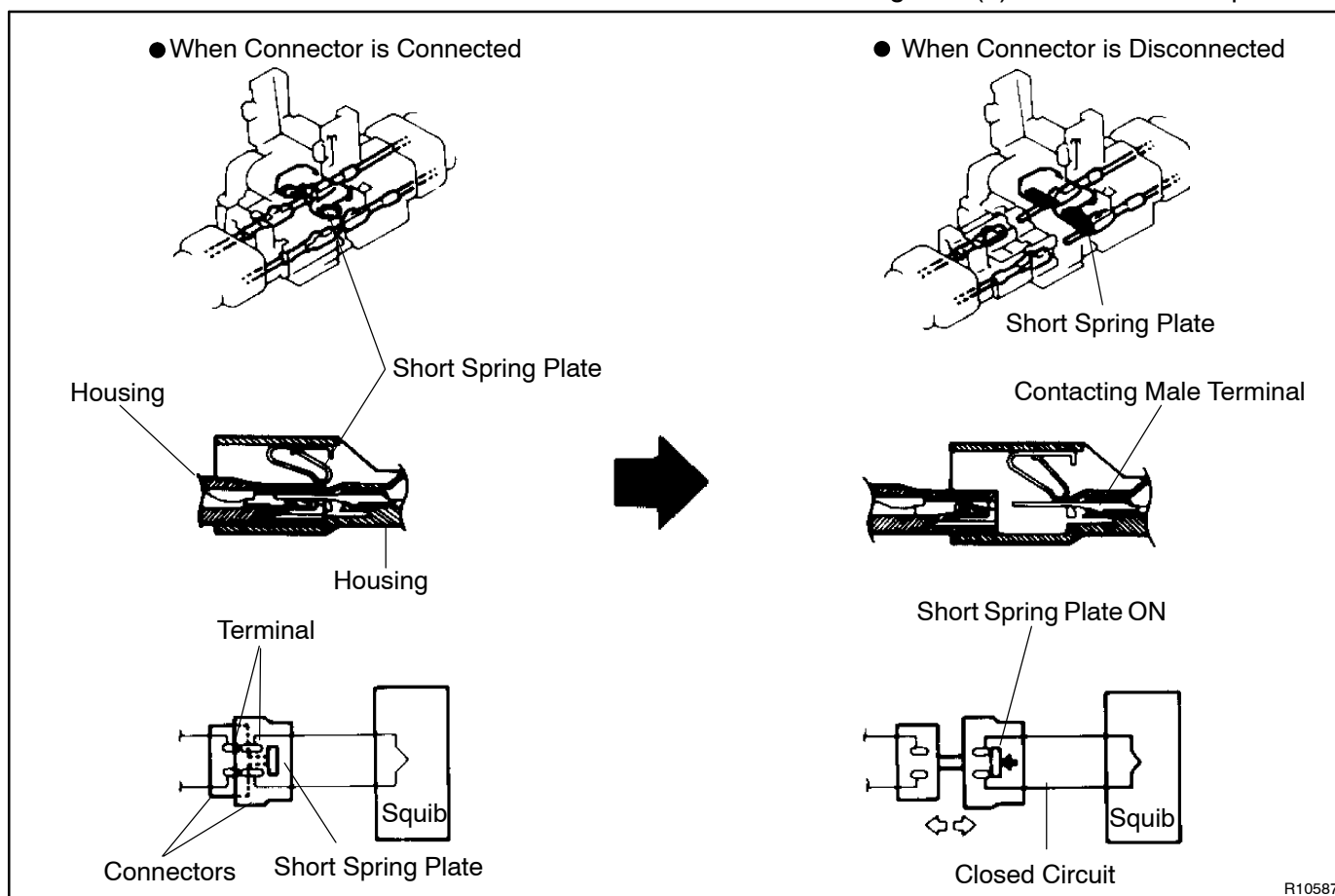

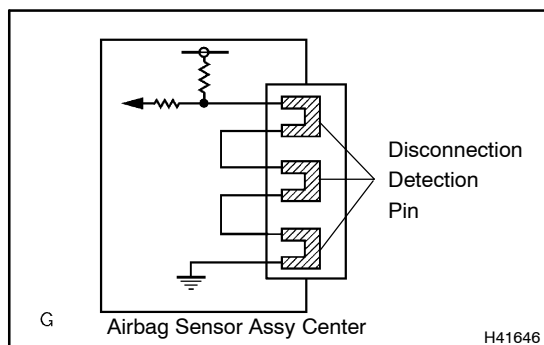

- (3) **Electrical connection check mechanism:**  
This mechanism electrically checks that connectors are connected correctly and completely. The electrical connection check mechanism is designed so that the disconnection detection pin connects with the diagnosis terminals when the connector housing lock is locked.

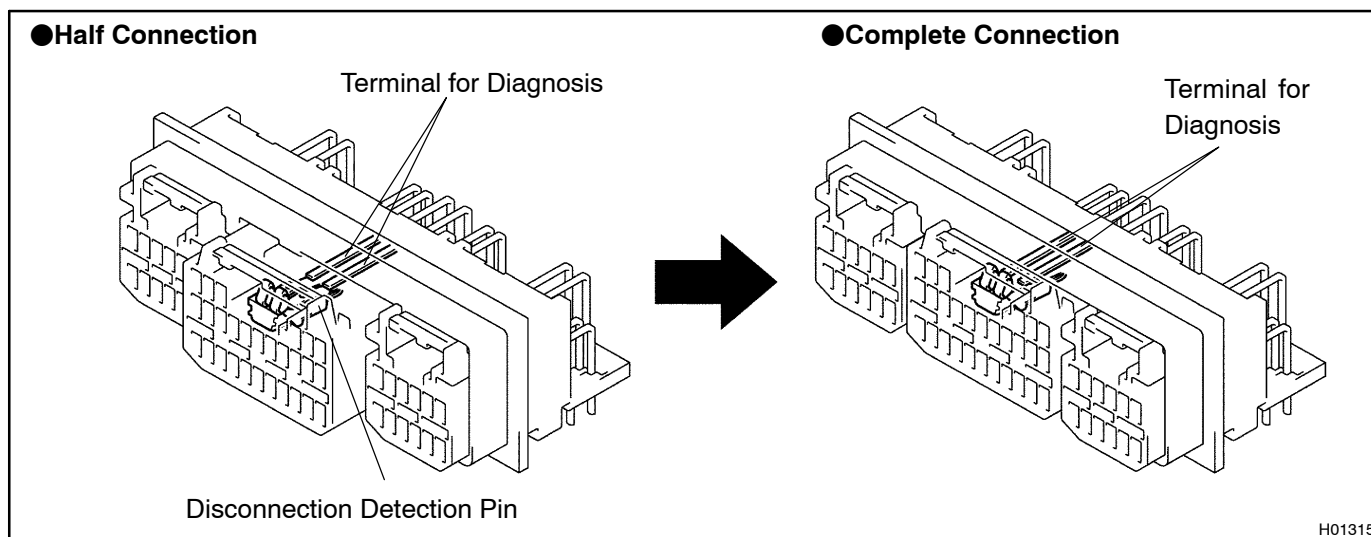

- (4) **Half connection prevention mechanism:**  
If the connector is not completely connected, the connector is disconnected due to the spring operation so that no continuity exists.

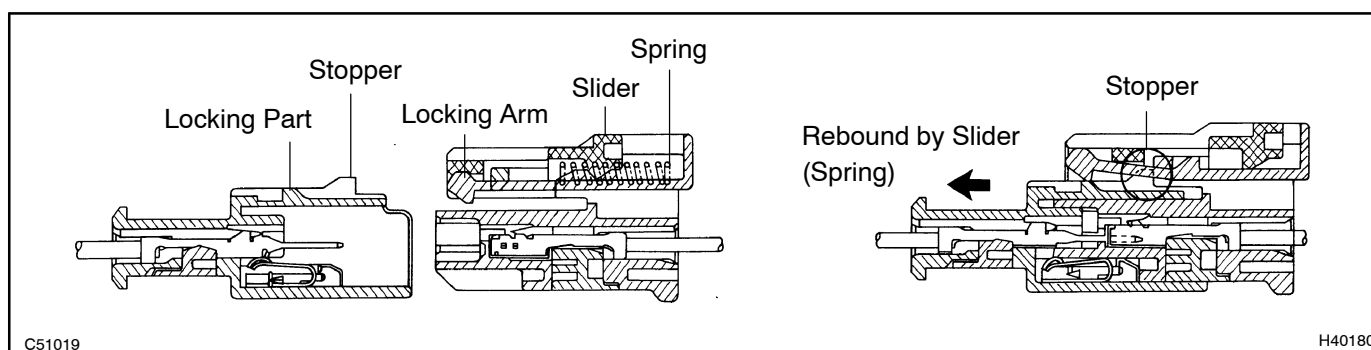

- (5) Connector lock mechanism:  
Locking the connector lock button connects the connector securely.

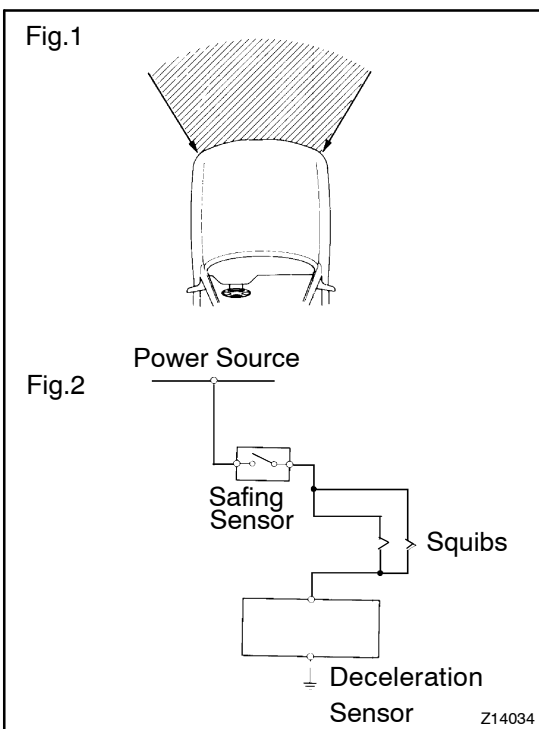
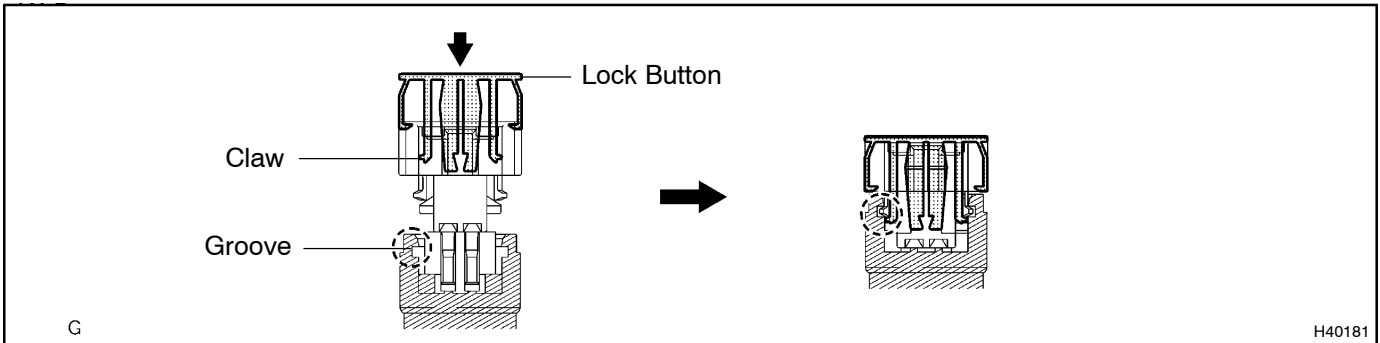

- (b) When the vehicle is involved in a frontal collision in the hatched area (Fig.1) and the shock is larger than the pre-determined level, the SRS is activated automatically. The safing sensor is designed to go on at a smaller deceleration rate than the airbag sensor. As illustrated in Fig.2, ignition is caused when current flows to the squib, which happens when the safing sensor and the deceleration sensor go on simultaneously. When a deceleration force acts on the sensors, 2 squibs in the driver airbag and front passenger airbag ignite and generate gas. The gas discharging into the driver airbag and front passenger airbag rapidly increases the pressure inside the bags, breaking the horn button assy and instrument panel. The deployment of the bags then ends, and the bags deflate as the gas is discharged through discharge holes at the bag's rear or side.

**2. DISCONNECTION OF CONNECTOR FOR HORN BUTTON ASSY**

- (a) Release the lock button (yellow part) of the connector using a screwdriver.
- (b) Insert the screwdriver tip between the connector and the base, and then raise the connector.

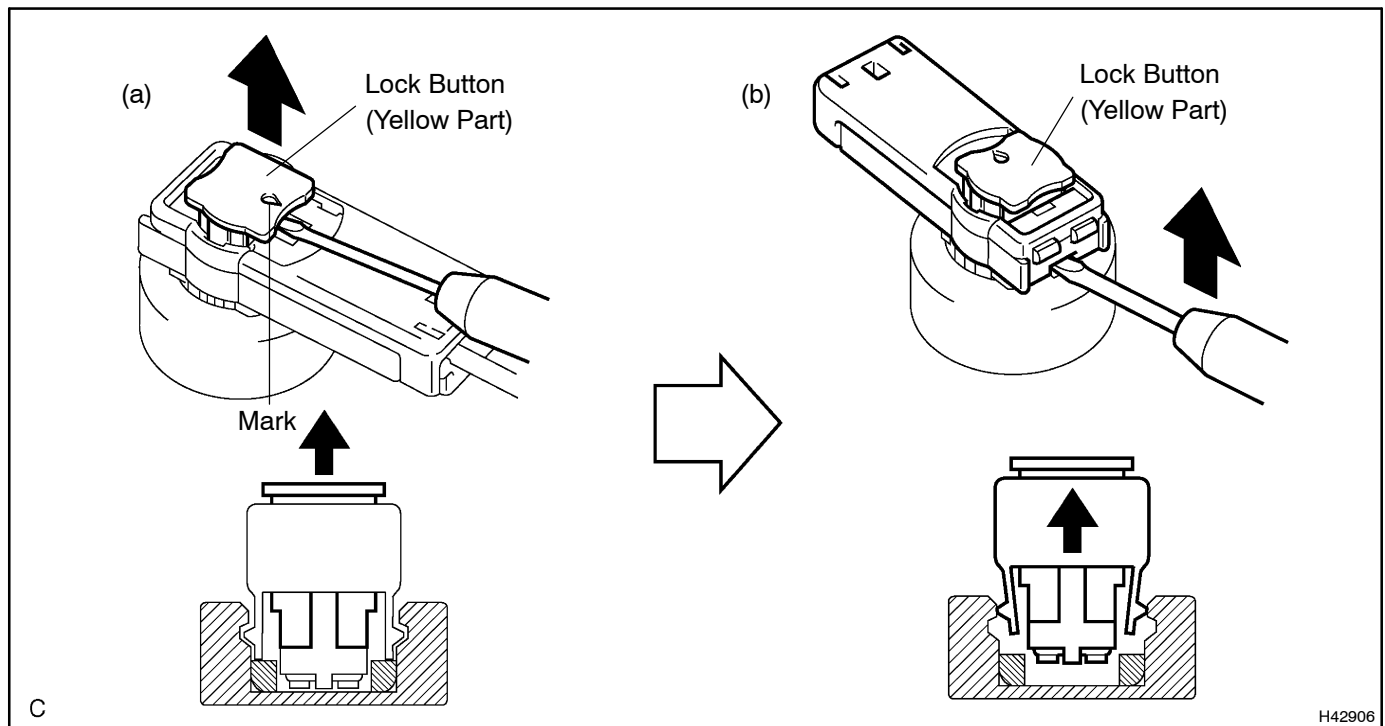

H42906

**3. CONNECTION OF CONNECTOR FOR HORN BUTTON ASSY**

- (a) Connect the connector.
- (b) Push down securely on the lock button (yellow part) of the connector. (When locking, a click sound can be heard.)

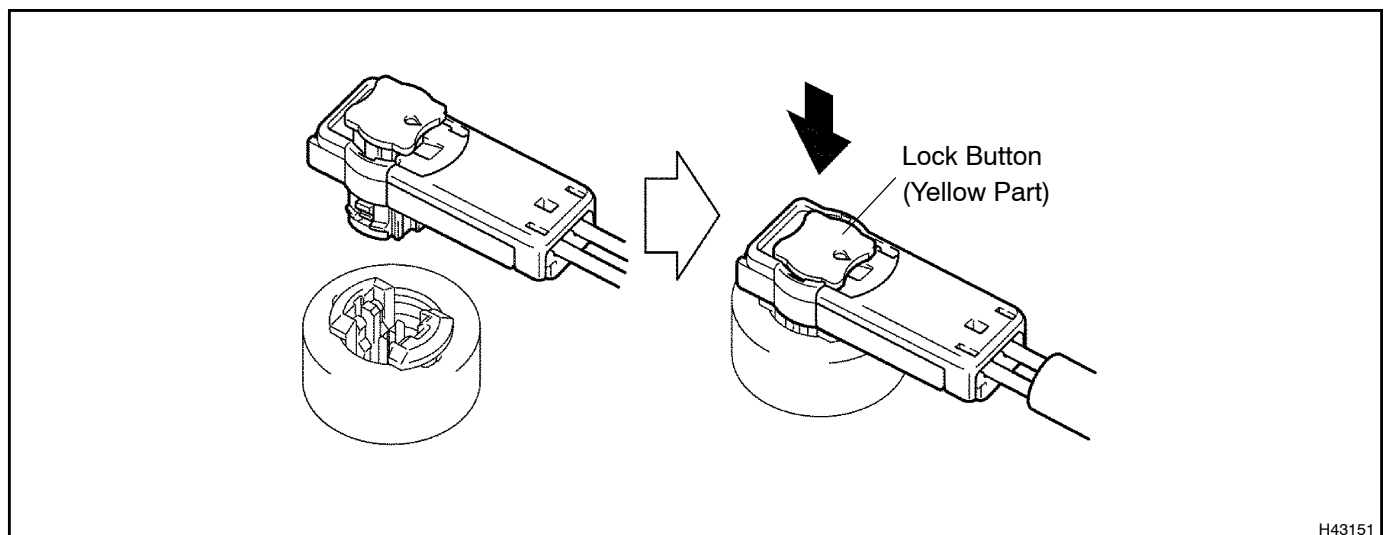

H43151

**4. DISCONNECTION OF CONNECTOR FOR FRONT SEAT AIRBAG ASSY**

- (a) Place a finger on the slider.
- (b) Slide the slider to release lock.
- (c) Disconnect the connector.

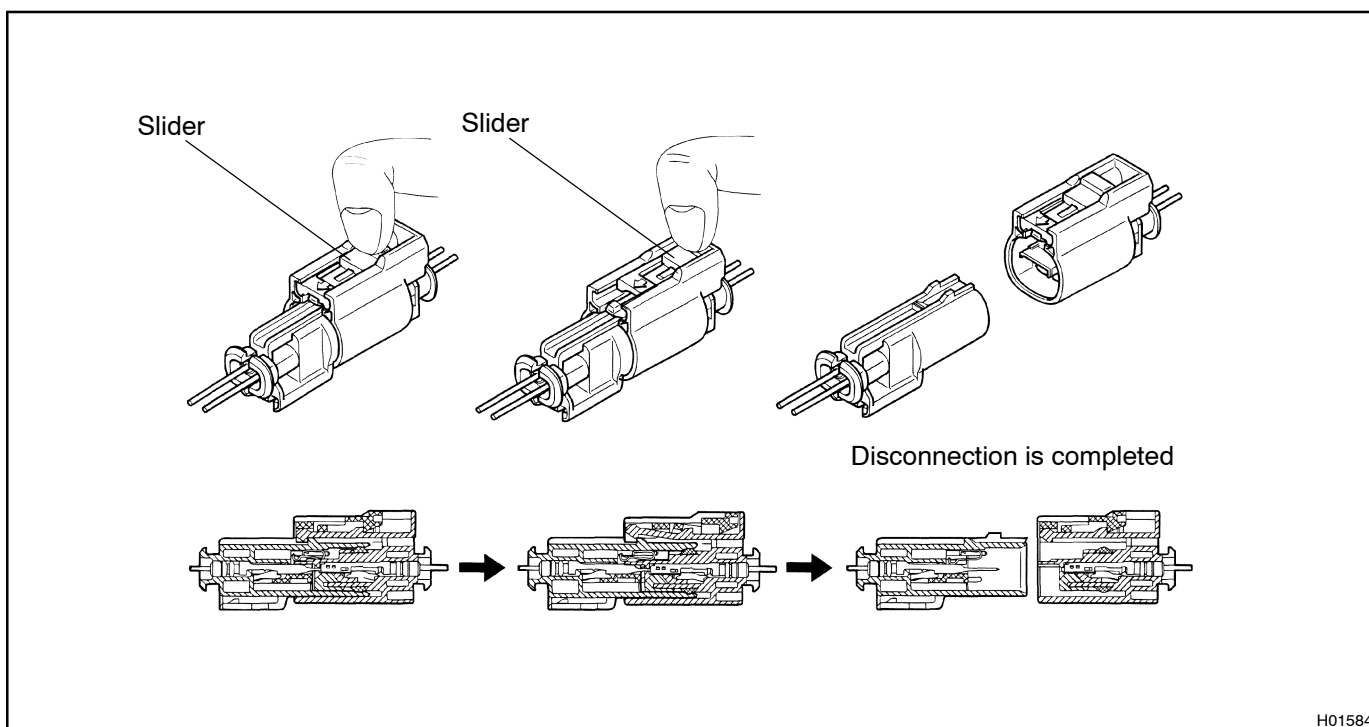
**5. CONNECTION OF CONNECTOR FOR FRONT SEAT AIRBAG ASSY**

- (a) Connect the connector as shown in the illustration. (When locking, make sure that the slider returns to its original position and a click sound can be heard.)

HINT:

When connecting, the slider will slide. Be sure not to touch the slider while connecting, as it may result in an insecure fit.

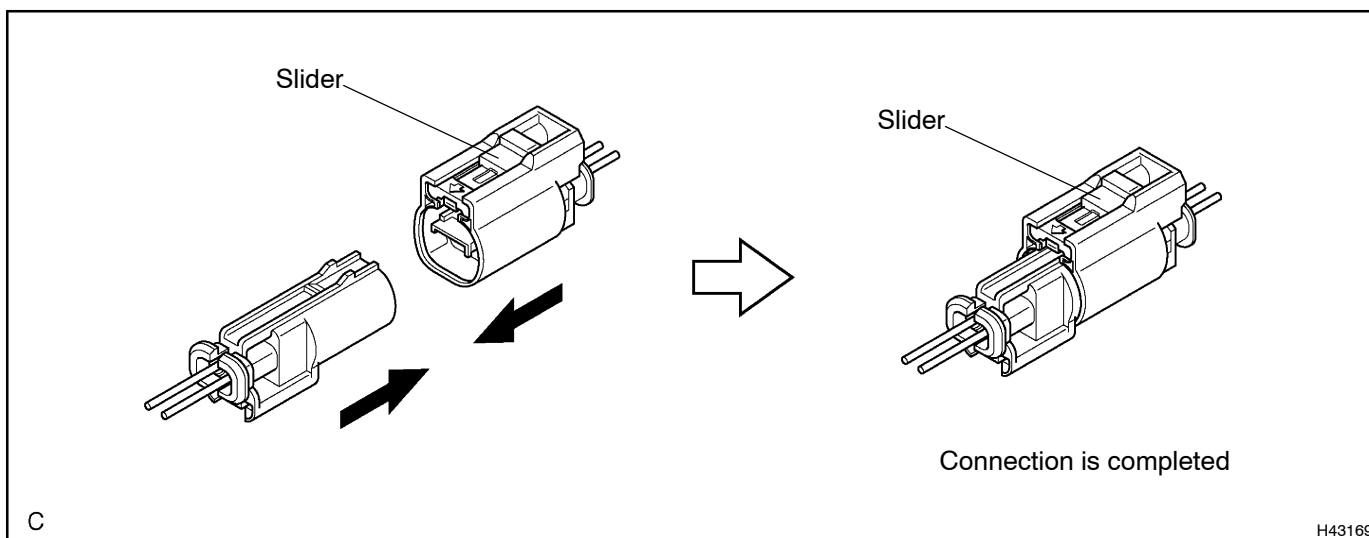

## 6. DISCONNECTION OF CONNECTORS FOR INSTRUMENT PANEL PASSENGER AIRBAG ASSY AND CURTAIN SHIELD AIRBAG ASSY

- (a) Place a finger on the slider.
- (b) Slide the slider to release lock.
- (c) Disconnect the connector.

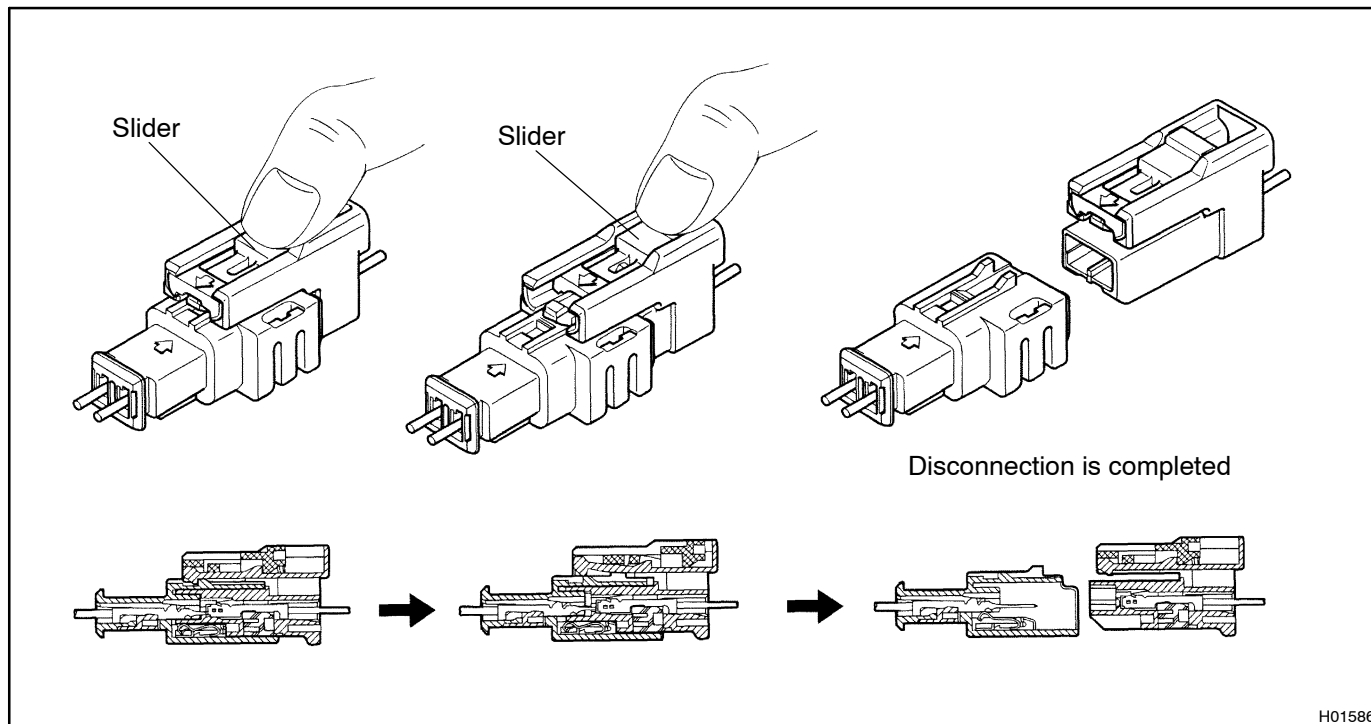

## 7. CONNECTION OF CONNECTORS FOR INSTRUMENT PANEL PASSENGER AIRBAG ASSY AND CURTAIN SHIELD AIRBAG ASSY

- (a) Connect the connector as shown in the illustration. (When locking, make sure that the slider returns to its original position and a click sound can be heard.)

### HINT:

When connecting, the slider will slide. Be sure not to touch the slider while connecting, as it may result in an insecure fit.

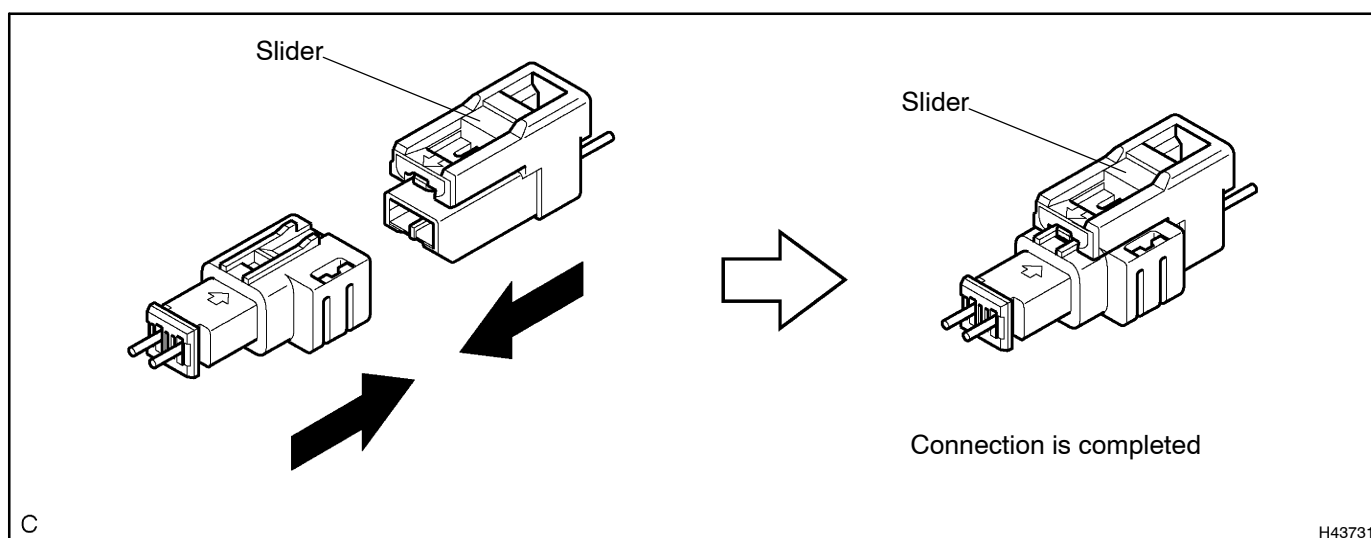



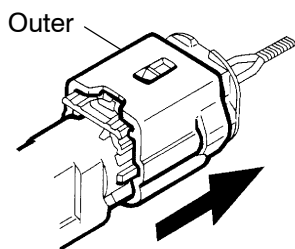

H02763

## 8. DISCONNECTION OF CONNECTORS FOR AIRBAG SENSOR FRONT AND SIDE AIRBAG SENSOR ASSY

- (a) While holding both outer flank sides, slide the outer in the direction shown by the arrow.
- (b) When the connector lock is released, the connectors are disconnected.

### HINT:

Be sure to hold both outer flank sides. Holding the top and bottom sides will make disconnection difficult.

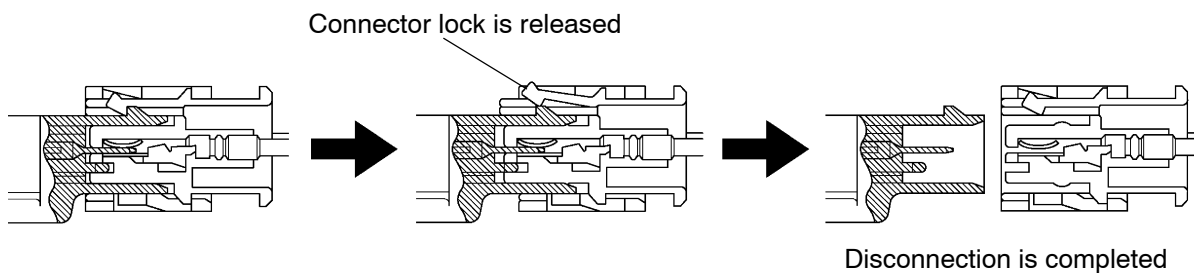

H02764

## 9. CONNECTION OF CONNECTORS FOR AIRBAG SENSOR FRONT AND SIDE AIRBAG SENSOR ASSY

- (a) Connect the connector as shown in the illustration. (When locking, make sure that the outer returns to its original position and a click sound can be heard.)

### HINT:

When connecting, the outer will slide. Be sure not to hold the outer while connecting, as it may result in an insecure fit.

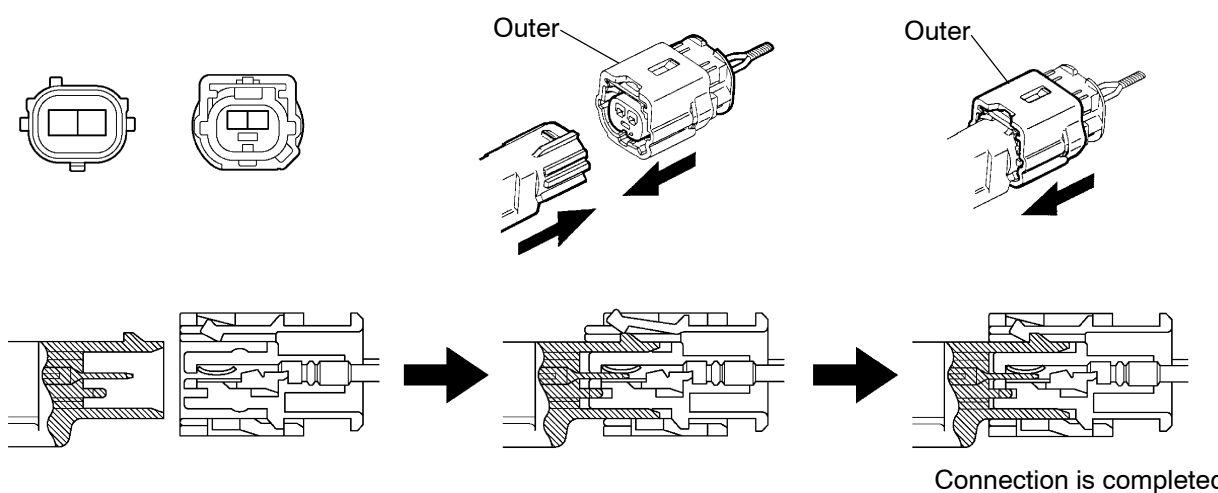

H02768